

Small print text at the top of the page, including a disclaimer about the accuracy of the information provided and a note about the use of the information for the purpose of the advertisement.

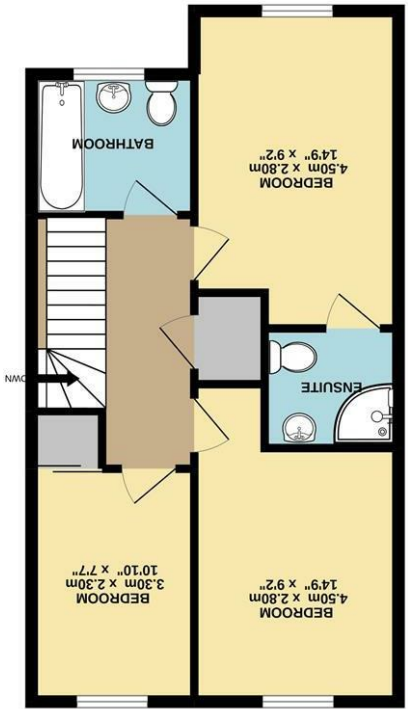

Energy Efficiency Rating	
Current	Potential
<p>England & Wales</p> <p>EU Directive 2002/91/EC</p> <p>Not energy efficient - higher running costs</p>	
<p>(1-20) G</p>	
<p>(21-30) F</p>	
<p>(31-50) E</p>	
<p>(51-60) D</p>	
<p>(61-80) C</p>	
<p>(81-90) B</p>	
<p>(91-100) A</p>	
<p>Very energy efficient - lower running costs</p>	



Norfolk Property online.

Gordon Avenue | Norwich | NR7
Guide price £325,000

Norfolk Property Online presents this exceptional three bedroom semi detached home in the popular suburb of Thorpe St Andrew. (Help to buy is available)

Accommodation briefly comprises; reception hall, cloakroom, lounge dining room through to a stunning kitchen. The first floor provides three bedrooms, the principle bedroom with an en suite and a family bathroom off the landing also.

Outside there is a good sized rear garden and off road parking for two vehicles to the front.

Quality materials, fixtures and fittings are being used throughout making for an impressive home with long term durability.

Specific details:

INTERNAL

- Air-source heating
- Digital and Sky+ TV points
- Oak faced internal doors
- Under floor heating on ground floor radiators on first floor
- Double glazed windows and doors throughout
- Smart touch screen heating controls

